



SINCE 2002

**FLUOROPOLYMER  
LINED PUMP  
PVDF / FEP / PFA**



**LASTING SOLUTION FOR  
HIGHLY CORROSIVE  
APPLICATION**

**SERIES - CPK**

**CHEM-PROOF**

# SERIES CPK

SERIES 'CPK' (PVDF, FEP, PFA) ARE TEFLON LINED PUMPS FOR HANDLING HIGHLY CORROSIVE FLUIDS INCLUDING HIGH TEMPERATURE SERVICES. HI-TECH LINING PROCESS IS EMPLOYED TO MANUFACTURE DEFECT FREE COMPONENTS. THESE PUMPS OFFER ECONOMIC ALTERNATIVE TO HIGHER ALLOY PUMPS LIKE HAST ALLOY-B, HAST ALLOY-C AND CERAMIC LINED PUMPS.

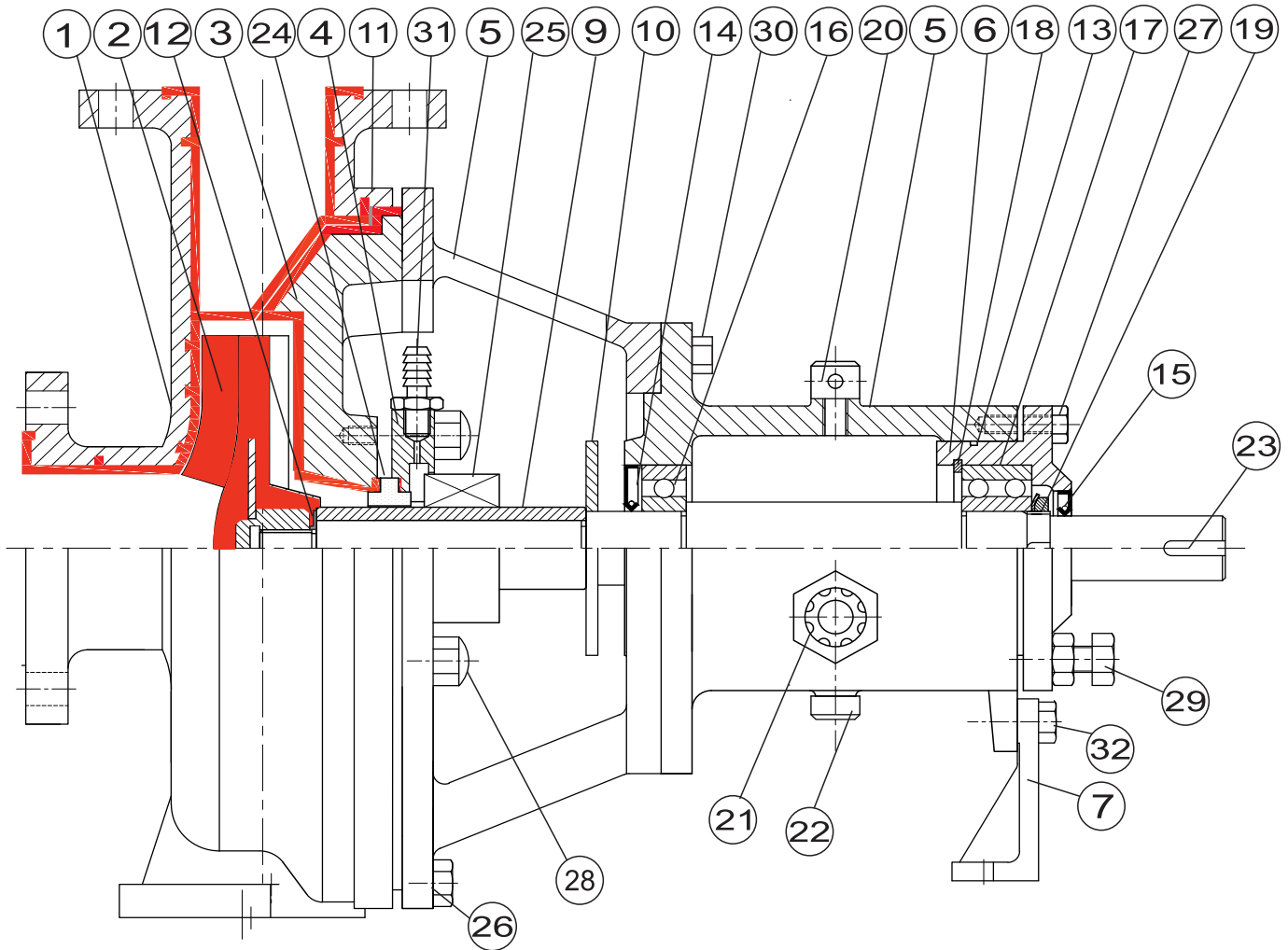

No.	Qty	Part Name	Material	No.	Qty	Part Name	Material	No.	Qty	Part Name	Material
1	1	CASING	FEP / PFA / PVDF	16	1	BEARING (IN-BOARD)	SKF . STD	31	2	NIPPLE	BRONZE
2	1	IMPELLER	FEP / PFA / PVDF	17	1	BEARING (OUT-BOARD)	SKF . STD	32	1	SUPPORT PLATE BOLT	SS 316
3	1	STUFFING BOX	FEP / PFA / PVDF	18	1	CIRCLIP	STEEL				
4	1	GLAND	HYLAM / SS 316	19	1	RING NUT & WASHER	MS				
5	1	BEARING FRAME	CAST IRON	20	1	BRETHER PLUG	MS				
6	1	BEARING CUP	CAST IRON	21	1	OIL INDICATOR	ALLIMINIUM				
7	1	SUPPORT PLATE	CAST IRON	22	1	DRAIN PLUG	MS				
8	1	SHAFT	SS 316	23	1	KEY	MS				
9	1	SLEEVE	CERAMIC	24	1	STATIONARY	CERAMIC				
10	1	DEFLECTOR	POLY PROPELYNE	25	1	MECH - SEAL	STD				
11	1	CASING GASKET	PTFE	26	8	CASING BOLT	SS 316				
12	1	IMPELLER GASKET	PTFE	27	4	BEARING CUP BOLT	SS 316				
13	1	BEARING CUP O-RING	VITON	28	4	STUFFING BOX BOLT	SS 316				
14	1	OIL SEAL (IN-BOARD)	NEOPRENE	29	2	JACKETING BOLT	SS 316				
15	1	OIL SEAL (OUT- BOARD)	NEOPRENE	30	4	ADAPTER BOLT	SS 316				

# FAMILY CURVES

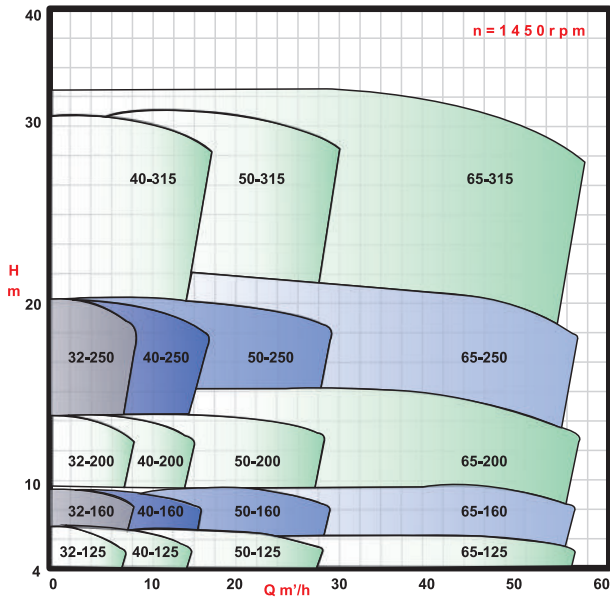

## DESIGN CONSTRUCTION DETAILS :-

Casing, stuffing box and impeller are offered in Various Material

- PFA ( Perfluoralkoxy )
- FEP ( Fluoroethylene propylene )
- PVDF ( Polyvinylidene fluoride )
- GFPP ( Glass filled polypropylene )
- PTFE ( Polytetrafluoroethylene )

\* Offered as standard

## IMPELLER :-

Solidly moulded, semi-open impeller with metal insert ensures high strength and durability. The impeller is dynamically balanced as per ISO 1940 to achieve minimum vibration and extended bearing life.

## SHAFT :-

As a standard shaft is offered EN-8 Material. Different materials can be offered on request.

## SHAFT SLEEVE :-

Sleeve is protecting the shaft from the attack of corrosive media and can be offered in various materials after confirming chemical compatibility.

- Ceramic (99.5% Alumina Oxide)\*
- Silicon Carbide
- Monel
- Alloy-20 (CN7M)
- Hastelloy-B
- Hastelloy-C
- Titanium

\* Offered as standard

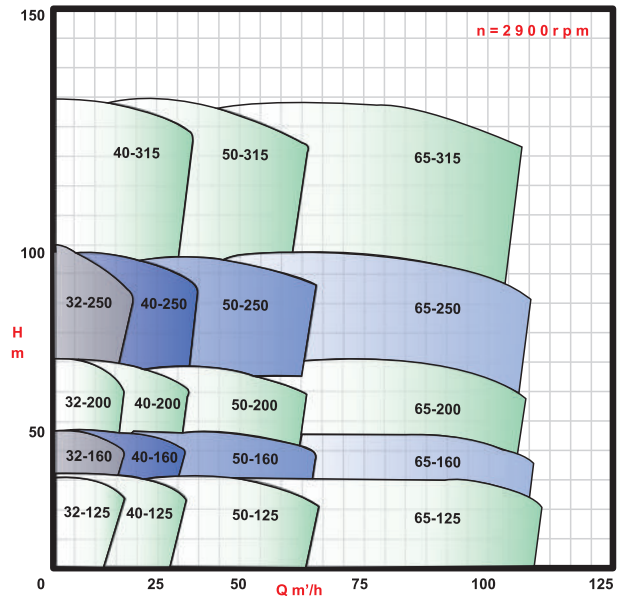

## MECHANICAL SEAL:-

As single externally mounted PTFE bellows & double Mechanical seal with various face combination is Offered after confriming chemical compatibility

- GFT v/s CERAMIC \*
- GFT v/s SILICON
- CARBON v/s CERAMIC
- CARBON v/s SILICON
- SILICON v/s SILICON

\* Offered as standard

## SEALING :-

'O' Ring and Gaskets Sealing are provided in the joints to ensure better sealing even at high pressure.

## ACCESSORIES

### PRIMING CHAMBER :-

This is specially used for negative suction. It is effective in handling liquids with slurry or particles, as it does not get clogged as easily as the foot valve.

### TROLLEY :-

A specially designed, vibration free trolley keeps the pump moblie, whenever required. Further the trolley can also be provided with FRV coating on the parts exposed to chemical drip.

**MFG UNIT:-**



*SINCE 2002*

## ***CHEM-PROOF PUMPS (I) PVT. LTD***

THE PERFECT PUMPING TECHNOLOGY

G-1602 Raj Estate, kashimira Road, Mira road (east), Mumbai 401 103, INDIA.

Phone: +91 9175467779 , 9004407779 , 9004179777

Website: [www.chemproofpumps.com](http://www.chemproofpumps.com) E-mail: [sales@chemproofpumps.com](mailto:sales@chemproofpumps.com) / [chemproof2021@gmail.com](mailto:chemproof2021@gmail.com)

AUTHORISED DEALER



**We reserve the right to change specification without notice.**